

SPECIFICATION SHEET

C SERIES COMMERCIAL STYLE SPRINGWOUND AUTO OFF IN-WALL TIMER

APPLICATIONS

- Ventilating fans.
- HVAC.
- Whirlpools.
- Motors and pumps.

FEATURES

VARIABLE TIMING:

Twist knob for time ON setting. Time ON lengths from 15 minutes to 12 hour vary by model.

HOLD FEATURE:

Some models have position for constant ON.

EASY SET:

No adjustments. Just wire and go!

EASY WIRING:

No neutral required. Great for retrofit!

SWITCH TYPE:

SPDT "2 in 1" contacts wire as SPST also, except C460M and C412H are DPST.

COLOR:

Metal-brushed aluminum.

WALL PLATE:

Includes real metal wall plate with screw mounting, to add extra security for commercial applications.

SPECIFICATIONS

INPUT VOLTAGE:

125/250/277VAC, 50/60Hz.

TERMINAL SIZE:

#12AWG.

OPERATING TEMPERATURE:

32 °F to 122 °F (0 °C to 50 °C).



*Wallplate included

WIRING DIAGRAMS

USE FOR SPST



USE FOR SPDT

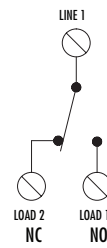

USE FOR DPST

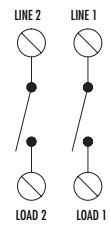

ORDERING INFO

| CAT. NO. | UPC CODE | HOLD FEATURE |
|-----------------------|----------|--------------|
| 15 MINUTE MAX. | | |
| C515M | 15501 | No Hold |
| 30 MINUTE MAX. | | |
| C530M | 15503 | No Hold |
| 60 MINUTE MAX. | | |
| C560M | 15505 | No Hold |
| C560MH | 15506 | With Hold |
| C460M* | 15011 | No Hold |
| 2 HOUR MAX. | | |
| C502H | 15507 | No Hold |
| 6 HOUR MAX. | | |
| C506H | 15511 | No Hold |
| 12 HOUR MAX. | | |
| C512H | 15513 | No Hold |
| C512HH | 15514 | With Hold |
| C412H* | 15010 | No Hold |

CONTACT RATINGS

| TYPE | VOLTAGE (VAC) | RATING |
|-----------|---------------|--------|
| Resistive | 125 | 20A |
| | 250 | 10A |
| | 277 | 10A |
| Inductive | 125 | 20A |
| | 250 | 10A |
| | 277 | 10A |
| Tungsten | 125 | 7A |
| Motor | 125 | 1HP |
| | 250 | 2HP |

*DPST switch type.

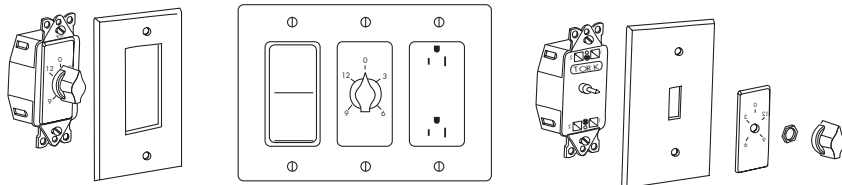

CAUTION: This timer is not to be used in precision timing applications where inaccurate timing could have dangerous consequences (i.e. sun lamp, sauna, etc.).