

## Vinyl Insulated Ring Terminals

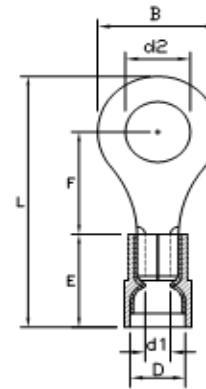

Drawn - SD

Approved - KM

Material - Copper / Vinyl Insulation

Title - Vinyl Insulated Ring Terminals



Part Number	Wire Range	Insulated Color	Electrical Rating Max	d2	B	F	L	E	D	d1
R22-6V	22-18 AWG	RED	75C / 300 Volts	0.1456	0.3149	0.2755	0.8267	0.3937	0.1614	0.0669
R22-8V	22-18 AWG	RED	75C / 300 Volts	0.1692	0.3149	0.2755	0.8267	0.3937	0.1614	0.0669
R22-10V	22-18 AWG	RED	75C / 300 Volts	0.2086	0.3149	0.2755	0.8267	0.3937	0.1614	0.0669
R22-14V	22-18 AWG	RED	75C / 300 Volts	0.2559	0.4566	0.4370	1.0551	0.3937	0.1614	0.0669
R22-56V	22-18 AWG	RED	75C / 300 Volts	0.3250	0.4640	0.4340	1.0940	0.4580	0.2070	0.1460
R22-38V	22-18 AWG	RED	75C / 300 Volts	0.4130	0.5900	0.4340	1.0940	0.4580	0.2070	0.1460
R16-6V	16-14 AWG	BLUE	75C / 300 Volts	0.1456	0.2598	0.2480	0.7677	0.3937	0.1771	0.0905
R16-8V	16-14 AWG	BLUE	75C / 300 Volts	0.1692	0.3346	0.3070	0.8661	0.3937	0.1771	0.0905
R16-10V	16-14 AWG	BLUE	75C / 300 Volts	0.2086	0.3346	0.3070	0.8661	0.3937	0.1771	0.0905
R16-14V	16-14 AWG	BLUE	75C / 300 Volts	0.2559	0.4724	0.4330	1.0629	0.3937	0.1771	0.0905
R16-56V	16-14 AWG	BLUE	75C / 300 Volts	0.3307	0.4724	0.4330	1.0629	0.3937	0.1771	0.0905
R16-38V	16-14 AWG	BLUE	75C / 300 Volts	0.4133	0.5354	0.5472	1.2086	0.3937	0.1771	0.0905
R16-50V	16-14 AWG	BLUE	75C / 300 Volts	0.5350	0.7550	0.5470	1.2080	0.3930	0.1770	0.0900
R12-6V	12-10 AWG	YELLOW	75C / 300 Volts	0.1456	0.3740	0.3267	1.0039	0.4921	0.2559	0.1338
R12-8V	12-10 AWG	YELLOW	75C / 300 Volts	0.1692	0.3740	0.3267	1.0039	0.4921	0.2559	0.1338
R12-10V	12-10 AWG	YELLOW	75C / 300 Volts	0.2086	0.3740	0.3267	1.0039	0.4921	0.2559	0.1338
R12-14V	12-10 AWG	YELLOW	75C / 300 Volts	0.2559	0.4724	0.4133	1.1417	0.4921	0.2559	0.1338
R12-56V	12-10 AWG	YELLOW	75C / 300 Volts	0.3307	0.5905	0.5393	1.3267	0.4921	0.2559	0.1338
R12-38V	12-10 AWG	YELLOW	75C / 300 Volts	0.4133	0.5905	0.5393	1.3267	0.4921	0.2559	0.1338
R12-50V	12-10 AWG	YELLOW	75C / 300 Volts	0.5118	0.7559	0.6299	1.4999	0.4921	0.2559	0.1338
R8-10V	8 AWG	RED	75C / 300 Volts	0.2080	0.3740	0.3260	1.2710	0.6550	0.3610	0.1910
R8-14V	8 AWG	RED	75C / 300 Volts	0.2550	0.4720	0.4130	1.2710	0.6550	0.3610	0.1910
R8-38V	8 AWG	RED	75C / 300 Volts	0.4310	0.5900	0.5390	1.2710	0.6550	0.3610	0.1910
R8-50V	8 AWG	RED	75C / 300 Volts	0.5350	0.8360	0.7000	1.2560	0.6550	0.3610	0.1910
R8-56V	8 AWG	RED	75C / 300 Volts	0.3250	0.8650	0.4210	1.2710	0.6550	0.3610	0.1910