

# CONNECTORS

## Compression Connectors

### Short Barrel Copper Lugs Two Hole with Peep Hole GL-N Series



#### FEATURES

- Produced from high conductivity copper tubing.
- Peep hole allows easy inspection of the termination to assure complete cable insertion.
- Tin-plated to provide corrosion and low contact resistance.
- Marked with die index and color coded.
- Listed for 35KV maximum when properly installed.
- For applications greater than 2000V, install to cable manufacturer voltage stress relief instructions.
- **Note:** Part numbers ending in "X" have no peep hole.

#### SPECIFICATIONS

- UL486A Listed Wire Connector.
- UL467 Grounding & Bonding (Sizes 8 AWG - 3/0 AWG).
- cULus 155027.
- Max ampacity is based on NEC 310.15, insulation type, and conductor material. Please consult your current NEC manual..
- \* CLASS B OR C BUILDING WIRE CU CABLE ONLY.
- **Temperature Rating:** 90 °C.
- **Voltage:** 600V max.
- 9CU.

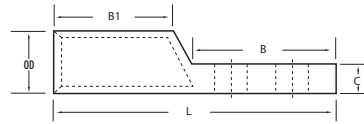
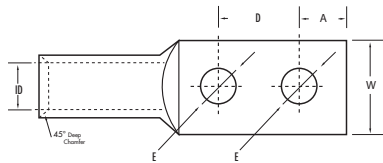

**\*EXPANDED WIRE RANGE** when installed with NSI N12ID dieless compression tool.  
UL Listed with other tools:  
**FOR TOOL/DIE CRIMPING INFORMATION, PLEASE SEE TABLE ON PAGE 87**

CAT. NO.	WIRE RANGE	EXPANDED WIRE RANGE*	COLOR CODE	BOLT SIZE (IN.)	MTG. HOLE SPACING (D) (IN.)	I.D. (IN.)	O.D. (IN.)	LENGTH (L) (IN.)	WIDTH (W) (IN.)	END OF CONN TO CTR. (A) (IN.)	TANG LENGTH (B) (IN.)	BARREL LENGTH (B1) (IN.)	TANG THICKNESS (C) (IN.)	MTG. HOLE DIA. (E) (IN.)	STD. CTN. QTY.
GL6N-141	6 AWG	6 - 8 AWG	Blue	1/4	0.625	0.205	0.295	2.087	0.421	0.280	1.260	0.709	0.083	0.252	100
GL6N-141X	6 AWG	6 - 8 AWG	Blue	1/4	0.625	0.205	0.295	2.087	0.421	0.280	1.260	0.709	0.083	0.252	100
GL6N-143	6 AWG	6 - 8 AWG	Blue	1/4	1.000	0.205	0.295	2.638	0.421	0.280	1.811	0.709	0.083	0.252	100
GL6N-38	6 AWG	6 - 8 AWG	Blue	3/8	1.000	0.205	0.295	2.638	0.488	0.382	1.811	0.709	0.087	0.413	100
GL4N-141	4 AWG	4 - 6 AWG	Gray	1/4	0.625	0.252	0.343	2.087	0.488	0.280	1.260	0.709	0.087	0.252	100
GL4N-38	4 AWG	4 - 6 AWG	Gray	3/8	1.000	0.252	0.343	2.677	0.488	0.382	1.811	0.748	0.087	0.413	100
GL2N-141	2 AWG	2 - 6 AWG	Brown	1/4	0.625	0.315	0.421	2.283	0.602	0.280	1.260	0.827	0.102	0.252	50
GL2N-141X	2 AWG	2 - 6 AWG	Brown	1/4	0.625	0.315	0.421	2.283	0.602	0.280	1.260	0.827	0.102	0.252	50
GL2N-142	2 AWG	2 - 6 AWG	Brown	1/4	0.750	0.315	0.421	2.362	0.602	0.280	1.378	0.827	0.102	0.252	50
GL2N-143	2 AWG	2 - 6 AWG	Brown	1/4	1.000	0.315	0.421	2.795	0.602	0.280	1.811	0.827	0.102	0.252	50
GL2N-38	2 AWG	2 - 6 AWG	Brown	3/8	1.000	0.315	0.421	2.835	0.602	0.280	1.811	0.827	0.102	0.413	50
GL2N-38X	2 AWG	2 - 6 AWG	Brown	3/8	1.000	0.315	0.421	2.835	0.602	0.280	1.811	0.827	0.102	0.413	50
GL1N-38	1 AWG	1 - 6 AWG	Green	3/8	1.000	0.350	0.463	3.024	0.672	0.345	1.842	0.955	0.106	0.404	50
GL10N-38	1/0 AWG	1/0 - 6 AWG	Pink	3/8	1.000	0.390	0.520	2.835	0.744	0.382	1.811	0.827	0.126	0.413	50
GL10N-38X	1/0 AWG	1/0 - 6 AWG	Pink	3/8	1.000	0.390	0.520	2.835	0.744	0.382	1.811	0.827	0.126	0.413	50