

# CONNECTORS

## Compression Connectors

### Short Barrel Copper Lugs One Hole with Peep Hole GL Series Cont'd



#### FEATURES

- Produced from high conductivity copper tubing.
- Peep hole allows easy inspection of the termination to assure complete cable insertion.
- Tin-plated to provide corrosion and low contact resistance.
- Marked with die index and color coded.
- Listed for 35KV maximum when properly install applications greater than 2000V, installed to cable manufacturer voltage stress relief instructions.

#### SPECIFICATIONS

- UL486A Listed Wire Connector.
- UL467 Grounding & Bonding (Sizes 8 AWG - 3/0 AWG).
- cULus Listed 155027.
- Max ampacity is based on NEC 310.15, insulation type, and conductor material. Please consult your current NEC manual..
- \* CLASS B OR C BUILDING WIRE CU CABLE ONLY.
- **Temperature Rating:** 90 °C.
- **Voltage:** 600V
- 9CU.

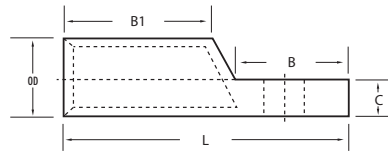
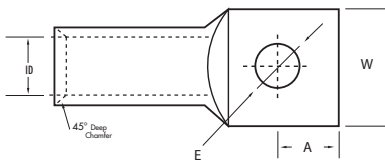

**\*EXPANDED WIRE RANGE** when installed with NSI N121D dieless compression tool.  
UL Listed with other tools:

**FOR TOOL/DIE CRIMPING INFORMATION,  
PLEASE SEE TABLE ON PAGE 87**

CAT. NO.	WIRE RANGE	EXPANDED WIRE RANGE*	COLOR CODE	BOLT SIZE (IN.)	BARREL I.D. (IN.)	BARREL O.D. (IN.)	LENGTH (L) (IN.)	WIDTH (W) (IN.)	END OF CONN TO CTR. (A) (IN.)	TANG LENGTH (B) (IN.)	BARREL LENGTH (B1) (IN.)	TANG THICKNESS (C) (IN.)	MTG. HOLE DIA. (E) (IN.)	STD. CTN. QTY.
GL2038	2/0 AWG	2/0 - 4 AWG	Black	3/8	0.441	0.563	2.244	0.815	0.472	1.063	0.945	0.118	0.413	25
GL2048	2/0 AWG	2/0 - 4 AWG	Black	1/2	0.441	0.563	2.244	0.815	0.472	1.063	0.945	0.118	0.512	25
GL3038	3/0 AWG	3/0 - 2 AWG	Orange	3/8	0.492	0.622	2.362	0.902	0.472	1.063	0.984	0.126	0.413	25
GL3048	3/0 AWG	3/0 - 2 AWG	Orange	1/2	0.492	0.622	2.362	0.902	0.472	1.063	0.984	0.126	0.512	25
GL4038	4/0 AWG	4/0 - 1 AWG	Purple	3/8	0.547	0.689	2.362	1.000	0.472	1.063	0.984	0.134	0.413	25
GL4048	4/0 AWG	4/0 - 1 AWG	Purple	1/2	0.547	0.689	2.362	1.000	0.472	1.063	0.984	0.134	0.512	25
GL25038	250 MCM	250 MCM - 1/0 AWG	Yellow	3/8	0.594	0.752	2.480	1.091	0.472	1.063	1.063	0.150	0.413	25
GL25048	250 MCM	250 MCM - 1/0 AWG	Yellow	1/2	0.594	0.752	2.480	1.091	0.472	1.063	1.063	0.150	0.512	25
GL30048	300 MCM	300 MCM - 2/0 AWG	White	1/2	0.657	0.815	2.480	1.189	0.520	1.063	1.063	0.150	0.512	12
GL35038	350 MCM	350 MCM - 3/0 AWG	Red	3/8	0.692	0.875	1.625	1.281	0.395	0.875	1.112	0.173	0.391	12
GL35048	350 MCM	350 MCM - 3/0 AWG	Red	1/2	0.701	0.874	2.606	1.276	0.520	1.063	1.102	0.165	0.512	12
GL40048	400 MCM	400 MCM - 4/0 AWG	Blue	1/2	0.764	0.949	3.079	1.386	0.520	1.378	1.181	0.177	0.512	6
GL50048	500 MCM	500 - 250 MCM	Brown	1/2	0.835	1.063	3.276	1.539	0.520	1.378	1.378	0.217	0.512	6
GL50058	500 MCM	500 - 250 MCM	Brown	5/8	0.835	1.063	3.276	1.539	0.520	1.378	1.378	0.217	0.669	6
GL60048	600 MCM	600 - 250 MCM	Green	1/2	0.925	1.189	3.504	1.717	0.520	1.457	1.496	0.252	0.512	6
GL60058	600 MCM	600 - 250 MCM	Green	5/8	0.925	1.189	3.504	1.717	0.689	1.457	1.496	0.252	0.669	6
GL75048	750 MCM	750 - 500 MCM	Black	1/2	1.022	1.295	3.866	1.760	0.685	1.550	1.743	0.277	0.541	3
GL75058	750 MCM	750 - 500 MCM	Black	5/8	1.031	1.311	4.370	1.902	0.689	1.850	1.850	0.268	0.669	3