

CONNECTORS

Compression Connectors

Long Barrel, Copper Lugs Two Hole
LN Series Cont'd



FEATURES

- Produced from high conductivity copper tubing.
- Allows easy inspection of the termination to assure complete cable insertion.
- Tin-plated to provide corrosion and low contact resistance.
- Marked with die index and color coded.
- Listed for 35KV maximum when properly installed.
- For applications greater than 2000V, installed to cable Manufacturer for voltage stress relief instructions.

• Part Numbers ending in "P" have a "peep" or sight inspection hole.

SPECIFICATIONS

- UL486A Listed Wire Connector.
- UL467 Grounding & Bonding (Sizes 8 AWG - 3/0 AWG).
- Max ampacity is based on NEC 310.15, insulation type, and conductor material. Please consult your current NEC manual..
- * CLASS B OR C BUILDING WIRE CU CABLE ONLY.
- Temperature Rating: 90 °C.
- Voltage: 600V.
- 9CU.

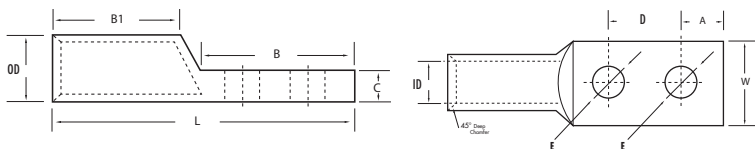

***EXPANDED WIRE RANGE** when installed with NSI N12ID dieless compression tool.
UL Listed with other tools:
FOR TOOL/DIE CRIMPING INFORMATION, PLEASE SEE TABLE ON PAGE 87

CAT. NO.	WIRE RANGE	EXPANDED WIRE RANGE*	COLOR	BOLT SIZE (IN.)	MTG. HOLE SPACING (D) (IN.)	BARREL I.D.	BARREL O.D.	LENGTH (L) (IN.)	WIDTH (W)	END OF CONN TO CTR. (A) (IN.)	TANG LENGTH (B) (IN.)	BARREL LENGTH (B1) (IN.)	TANG THICKNESS (C) (IN.)	MTG. HOLE DIA. (E) (IN.)	STD. CTN. QTY.
L4N-14P	4 AWG	4 - 6 AWG	Gray	1/4"	0.625	0.250	0.340	2.360	0.490	0.280	1.260	0.980	0.090	0.261	100
L4N-141	4 AWG	4 - 6 AWG	Gray	1/4"	0.625	0.250	0.340	2.95	0.420	0.380	1.810	0.980	0.90	0.261	100
L4N-141P	4 AWG	4 - 6 AWG	Gray	1/4"	0.625	0.250	0.340	2.950	0.420	0.380	1.810	0.980	0.090	0.261	100
L4N-142	4 AWG	4 - 6 AWG	Gray	1/4"	0.750	0.250	0.340	2.95	0.420	0.380	1.810	0.980	0.90	0.261	100
L4N-142P	4 AWG	4 - 6 AWG	Gray	1/4"	0.750	0.250	0.340	2.950	0.420	0.380	1.810	0.980	0.090	0.261	100
L4N-38	4 AWG	4 - 6 AWG	Gray	3/8"	1.000	0.250	0.340	2.950	0.420	0.380	1.810	0.980	0.090	0.410	100
L4N-38P	4 AWG	4 - 6 AWG	Gray	3/8"	1.000	0.250	0.340	2.950	0.420	0.380	1.810	0.980	0.090	0.410	100
L4N-382	4 AWG	4 - 6 AWG	Gray	3/8"	0.750	0.250	0.340	4.090	0.870	0.620	2.990	0.980	0.120	0.410	100
L4N-382P	4 AWG	4 - 6 AWG	Gray	3/8"	0.750	0.250	0.340	4.090	0.870	0.620	2.990	0.980	0.120	0.410	100
L4N	4 AWG	4 - 6 AWG	Gray	1/2"	1.750	0.250	0.340	4.090	0.870	0.620	2.990	0.980	0.120	0.510	100
L4N-P	4 AWG	4 - 6 AWG	Gray	1/2"	1.750	0.250	0.340	4.090	0.870	0.620	2.990	0.980	0.120	0.510	100
L2N-14	2 AWG	2 - 6 AWG	Brown	1/4"	1.000	0.310	0.420	2.520	0.600	0.280	1.260	1.100	0.100	0.252	50
L2N-14P	2 AWG	2 - 6 AWG	Brown	1/4"	1.000	0.310	0.420	2.520	0.600	0.280	1.260	1.100	0.100	0.252	50
L2N-141	2 AWG	2 - 6 AWG	Brown	1/4"	0.625	0.310	0.420	2.520	0.600	0.280	1.260	1.100	0.100	0.250	50
L2N-141P	2 AWG	2 - 6 AWG	Brown	1/4"	0.625	0.310	0.420	2.520	0.600	0.280	1.260	1.100	0.100	0.250	50
L2N-142	2 AWG	2 - 6 AWG	Brown	1/4"	0.750	0.310	0.420	2.640	0.600	0.280	1.380	1.100	0.100	0.250	50
L2N-38	2 AWG	2 - 6 AWG	Brown	3/8"	1.000	0.310	0.420	3.070	0.600	0.380	1.810	1.100	0.100	0.410	50
L2N-38P	2 AWG	2 - 6 AWG	Brown	3/8"	1.000	0.310	0.420	3.070	0.600	0.380	1.810	1.100	0.100	0.410	50
L2N-382	2 AWG	2 - 6 AWG	Brown	3/8"	0.750	0.310	0.420	4.250	0.810	0.620	2.990	1.100	0.100	0.410	50
L2N-382P	2 AWG	2 - 6 AWG	Brown	3/8"	0.750	0.310	0.420	4.250	0.810	0.620	2.990	1.100	0.100	0.410	50
L2N-383	2 AWG	2 - 6 AWG	Brown	3/8"	1.750	0.310	0.420	4.250	0.810	0.620	2.990	1.100	0.100	0.410	50
L2N-383P	2 AWG	2 - 6 AWG	Brown	3/8"	1.750	0.310	0.420	4.250	0.810	0.620	2.990	1.100	0.100	0.410	50
L2N-56	2 AWG	2 - 6 AWG	Brown	5/16"	0.750	0.310	0.420	2.870	0.600	0.320	1.610	1.100	0.100	0.330	50
L2N	2 AWG	2 - 6 AWG	Brown	1/2"	1.750	0.310	0.420	4.250	0.810	0.620	2.990	1.100	0.100	0.510	50
L2N-P	2 AWG	2 - 6 AWG	Brown	1/2"	1.750	0.310	0.420	4.250	0.810	0.620	2.990	1.100	0.100	0.510	50
L1N-141	1 AWG	1 - 6 AWG	Green	1/4"	0.630	0.360	0.470	2.560	0.670	0.280	1.260	1.100	0.110	0.250	50