

# CONNECTORS

## Mechanical Connectors

### Copper Single/Double Solderless Lugs DE Series



#### SPECIFICATIONS

- UL486A Listed for Wire Connector.
- Temperature Rating: 90 °C, 9CU.
- Voltage: 600V max.



#### FEATURES

- Made of 99.98% pure electrolytic copper.
- Steel-plated screws to prevent rusting.
- 25 to 70 ampere sizes have slotted head screws.
- Larger sizes have hex head screws.
- For use with Copper wire only.

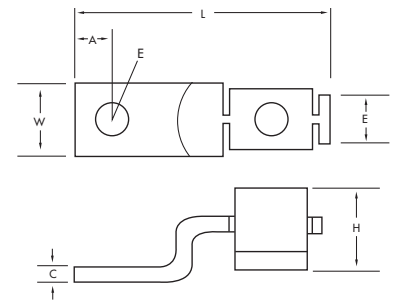
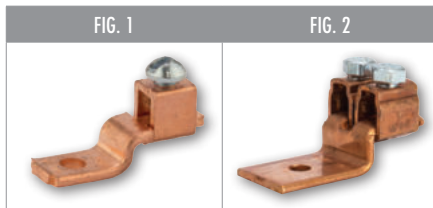

CAT.NO.	FIG. NO.	WIRE RANGE	MTG. BOLT SIZE	AMP RATING	MAX TORQUE VALUE (IN./LBS.)	HEX WRENCH SIZE	LENGTH (L)	WIDTH (W)	HEIGHT (H)	TANG LENGTH (A)	TANG THICKNESS (C)	MTG. HOLE DIA. (E)	STD. CTN. QTY.
DE703	1	10-14 AWG	1/4	25	60	Slotted	1.025	0.315	0.465	0.195	0.069	0.160	100
DE704	1	6-14 AWG	3/16	35	90	Slotted	1.190	0.380	0.500	0.230	0.070	0.250	100
DE705	1	2-8 AWG	5/16	70	125	Slotted	1.550	0.500	0.650	0.250	0.090	0.340	100
DE711	1	4-14 AWG	1/4	70	90	Slotted	1.310	0.500	0.560	0.250	0.080	0.280	50
DE706	1	1/0-8 AWG	1/4	125	150	Slotted	1.970	0.630	0.880	0.500	0.130	0.280	25
DE713	1	3/0-4 AWG	3/8	175	200	3/8	2.190	0.750	1.030	0.440	0.130	0.500	18
DE707	1	4/0-2 AWG	1/2	225	200	7/32	2.380	1.000	1.170	0.470	0.130	0.560	15
D899	2	4/0-2 AWG	5/8	450	200	5/8	3.200	1.502	1.720	0.915	0.190	0.405	6
DE710	1	350 MCM-1/0 AWG	3/4	300	250	3/4	3.025	0.998	2.310	0.450	0.186	0.403	10
DE708	1	500 MCM-4/0 AWG	15/16	400	300	15/16	4.320	1.497	2.200	0.840	0.190	0.403	2
DE709	1	1000-600 MCM	3/8	650	400	3/8	4.360	1.998	2.870	1.080	0.254	0.530	2