

## FP1248

### Low Voltage Framing Projector Track Fixture Track Systems

Job Information		
Project Name		Type
Location	Canadalite.com	
Quantity		Date
Contact/Phone	1(888)887-7038	
Notes		

#### Features

##### Body

Constructed of extruded 0.08" aluminum, the body features a ridged linear texturing to provide maximum heat dissipation. The front of the housing terminates with a bracket that would hold colour or other effect gels or filters. The top of the housing features a sliding door with screw lock revealing cavity with internal bracket to hold beam concentrator templates or gobo holders. The four sides of the housing contain slots for insertion of framing shutters (included) to cut output beam into a defined rectangle.

##### Beam Control

Two concave glass lenses inside the housing provide precise focusing for all three function – as a gobo projector, framing projector or beam concentrator – each connected to a tightening screw knob for independent positioning

##### Functionality

Gobo Projector – with gobo mounting

insert (included) installed into main housing, any custom gobo (by others) can be projected onto any desired surface. Insert only accepts steel card gobos (do not attempt with glass gobos).

Framing Projector – four framing shutters insert into narrow slots on all four sides of main projector housing. Inserted, shutters have complete independent motion for precise position and size of illuminated rectangle desired. Focus can be adjusted to provide either a soft or rigid, defined border around any frame or artwork.  
Beam Concentrator – two inserts provide four cutout templates to produce various size beams. Focusing can provide either a soft or hard border around the spotlight produced by the concentrator template.

##### Transformer

Solid state electronic transformers provide noise-free voltage reduction and operation. 120V AC to 12V AC.

##### Lamping

Porcelain socket for 12V MR16 lamps, 75 watts max, is located in lamp holder sub-assembly that is accessed through the rear of the main projector housing.

##### Adjustability

Lamp housing is controlled with two large plastic knobs that provide vertical angle setting for physically aiming the entire projector; 330° horizontal rotation and 135° vertical rotation.

##### Dimming

The track fixture is dimmable when used with electronic low voltage rated dimming controls only. 120V / 60Hz input; 12V output; 50W maximum load.

##### Compatibility

Liteline track fixtures are compatible with Juno®, Halo® and most brands configured to Halo® track system design.

##### Labels

• cCSAus listed.



#### Description

This multi-functional framing projector track head features a distinctive extruded aluminum construction and ridged linear design is textured to minimize heat dissipation. The fixture features dual lenses for precise focus, beam concentrators, gobo holders and four framing shutters to allow precise light cutoff.



**Notes:** Accessories should be ordered separately. For additional options please consult your Liteline representative. Juno is a registered trademark of Juno Lighting Group. Halo is a registered trademark of Cooper Lighting.

Due to our continued efforts to improve our products, product specifications are subject to change without notice.

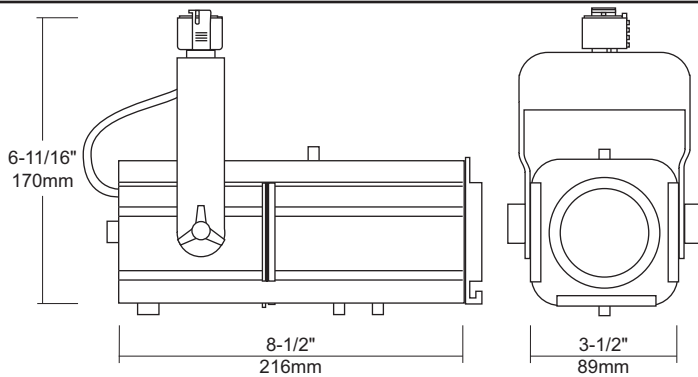

#### Ordering Guide



##### FP1248-BK

Black framing projector track fixture, 12V.



##### FP1248-WH

White framing projector track fixture, 12V.