

DESCRIPTION

The TC Recess LED offers standard efficiency without aesthetic compromise. These LED luminaires offer exceptional quality and performance powered by highly efficient Ultrasave LED source.

SPECIFICATION FEATURES

Construction

22 gauge galvanized steel painted white

Finish

22 gauge galvanized steel and high gloss enamel paint finish ensures maximum bonding and rust inhibition

Controls

The TC LED Troffer is powered by Ultrasave drivers and module

Shielding

Decorative frosted lens gives out exceptional light and is visually pleasing

Electrical

Long Life LED System complete with electrical driver to deliver the optimal performance. LED's available in a 3500K, 4000K and 5000K with a typical CRI: 80. Rated for 94,000 hours. Electronic Drivers are available in 120/277 and 347 Volt applications. Another advantage is that the drivers can offer a different lumen pack by just changing the driver cable. (Please see catalogue for more information)

Compliance

Modules and Drivers are UL recognized components and luminaires are cULus / DLC listed

Warranty

5 years

Driver and Module Access

Drivers can be accessed by removing the snap in lens and unscrewing the driver cover



**TC LED
DECORATIVE
TROFFER**

powered by
ULTRASAVE

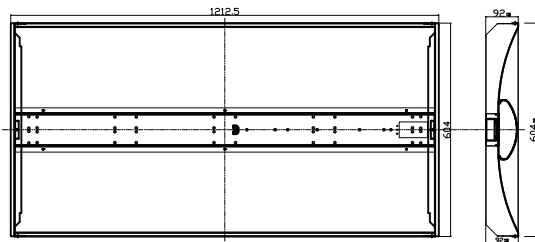

TC80LED08 / TC54LED04

Dimension

mm | 1213(L) x 604(W) x 92(D)
inch | 48"(L) x 24"(W) x 3.6"(D)

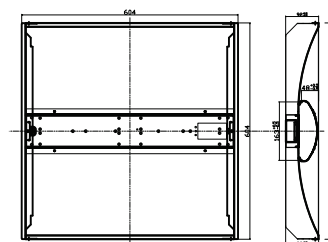



TC40LED04 / TC40LED02

Dimension

mm | 604(L) x 604(W) x 92(D)
inch | 24"(L) x 24"(W) x 3.6"(D)

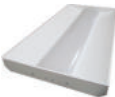
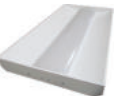
ORDERING CODE, ENERGY AND PERFORMANCE DATA

Model No.	Delivered Lumens (lm)	Input Watts (W)	Voltage (V)	Colour Temp. (K)	Efficacy (lm/W)	Status
 TC80LED08 2 x 4	8830	83	120M / 347	4000K	106	Stock
	8830	83	120M / 347	3500K / 5000K	99 / 110	MTO
	8270	79	120M / 347	3500K / 4000K / 5000K	99 / 105 / 110	MTO
	6870	65	120M / 347	3500K / 4000K / 5000K	100 / 106 / 111	MTO
 TC54LED04 2 x 4	5900	63	120M / 347	4000K	94	Stock
	5900	63	120M / 347	3500K / 5000K	89 / 98	MTO
	5300	56	120M / 347	3500K / 4000K / 5000K	90 / 95 / 99	MTO
	4300	45	120M / 347	3500K / 4000K / 5000K	91 / 96 / 100	MTO
 TC40LED04 2 x 2	4410	42	120M / 347	4000K	105	Stock
	4410	42	120M / 347	3500K / 5000K	99 / 110	MTO
	3240	31	120M / 347	3500K / 4000K / 5000K	99 / 104 / 110	MTO
	2250	22	120M / 347	3500K / 4000K / 5000K	97 / 102 / 107	MTO
 TC40LED02 2 x 2	3000	31	120M / 347	4000K	96	Stock
	3000	31	120M / 347	3500K / 5000K	91 / 100	MTO

OPTIONAL ACCESSORIES

Dimming Drivers (D) 120M/347V

SHIPPING DATA

Model No.	Weight
TC80LED08	10kg / 22lbs
TC54LED04	10kg / 22lbs
TC40LED04	5kg / 11lbs
TC40LED02	5kg / 11lbs

PHOTOMETRICS

Note: Photometric data result was obtained under clear lens with white reflectors condition.

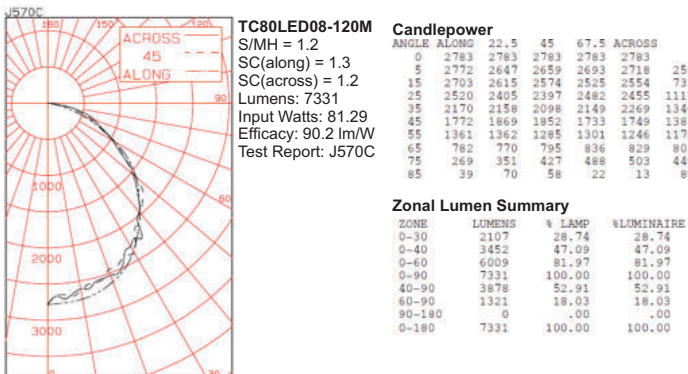

Coefficient of Utilization
Effective floor cavity reflectance = 20%

CC WALL	80	70	50	30	10	0
70	50	30	10	70	50	30
50	30	10	50	30	10	50
30	10	50	30	10	50	30
10	50	30	10	50	30	10
0	50	30	10	50	30	10

Note: Photometric data result was obtained under linear prismatic translucent lens with white reflectors condition.

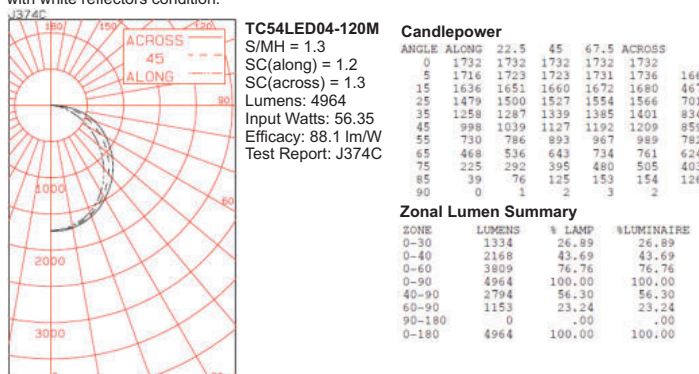

Coefficient of Utilization
Effective floor cavity reflectance = 20%

CC WALL	80	70	50	30	10	0
70	50	30	10	70	50	30
50	30	10	50	30	10	50
30	10	50	30	10	50	30
10	50	30	10	50	30	10
0	50	30	10	50	30	10



Energy Efficient Lighting Company Limited
331 Amber Street, Unit B, Markham, ON L3R 3J7 Canada
Tel: 905-415-8878 • 1-855-415-8878 | Fax: 905-415-8872 • 1-855-415-8872
Email: marketing@eelighting.ca | URL: www.eelighting.ca

Specifications and dimensions subject to change without notice.
Consult your Energy Efficient Lighting Representative
for availability and ordering information.

PHOTOMETRICS

Note: Photometric data result was obtained under translucent linear prismatic lens with white reflectors condition.

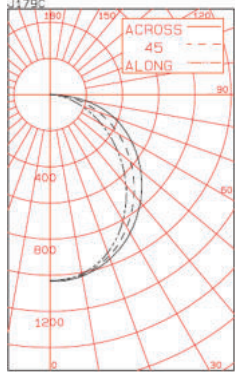

Candlepower

ANGLE	ALONG 22.5	45	67.5	ACROSS
0	1031	1031	1031	1031
5	1025	1025	1026	1030
15	976	979	987	994
25	873	883	905	923
35	731	747	786	820
45	571	595	653	700
55	407	440	510	565
65	256	290	360	423
75	123	150	212	269
85	23	32	54	66

Zonal Lumen Summary

ZONE	LUMENS	# LAMP	% LUMINAIRE
0-30	791	27.67	27.67
0-40	1280	44.77	44.77
0-60	2228	77.90	77.90
0-90	2861	100.00	100.00
40-90	1590	55.23	55.23
60-90	632	22.10	22.10
90-180	0	.00	.00
0-180	2861	100.00	100.00

Coefficient of Utilization
 Effective floor cavity reflectance = 20%

CC	80	70	50	30	10	0													
WALL	70	50	30	10	70	50	30	10	50	30	10	50	30	10	0				
RCR	0	1.191	1.191	1.191	1.191	1.161	1.161	1.161	1.161	1.111	1.111	1.111	1.061	1.061	1.061	1.021	1.021	1.021	1.000
	1	1.091	1.051	1.01	0.97	1.071	1.03	0.99	0.95	0.98	0.95	0.92	0.94	0.92	0.90	0.91	0.89	0.87	0.85
	2	1.00	0.93	0.86	0.81	0.98	0.91	0.85	0.80	0.87	0.82	0.78	0.84	0.80	0.76	0.81	0.77	0.74	0.72
	3	0.92	0.82	0.74	0.68	0.89	0.80	0.73	0.67	0.77	0.71	0.66	0.74	0.69	0.65	0.72	0.68	0.64	0.62
	4	0.85	0.73	0.65	0.58	0.82	0.72	0.64	0.58	0.69	0.63	0.57	0.67	0.61	0.57	0.65	0.60	0.56	0.54
	5	0.78	0.66	0.57	0.50	0.76	0.64	0.56	0.50	0.62	0.55	0.50	0.60	0.54	0.49	0.58	0.53	0.48	0.46
	6	0.72	0.59	0.50	0.44	0.70	0.58	0.50	0.44	0.56	0.49	0.43	0.54	0.48	0.43	0.53	0.47	0.42	0.40
	7	0.66	0.53	0.44	0.38	0.64	0.52	0.44	0.38	0.50	0.43	0.38	0.49	0.42	0.37	0.48	0.42	0.37	0.35
	8	0.61	0.48	0.40	0.34	0.60	0.47	0.39	0.34	0.46	0.38	0.33	0.45	0.38	0.33	0.43	0.37	0.33	0.31
	9	0.57	0.44	0.35	0.30	0.55	0.43	0.35	0.30	0.42	0.35	0.29	0.41	0.34	0.29	0.40	0.34	0.29	0.27
	10	0.53	0.40	0.32	0.26	0.52	0.39	0.32	0.26	0.38	0.31	0.26	0.37	0.31	0.26	0.36	0.30	0.26	0.24



Energy Efficient Lighting Company Limited
 331 Amber Street, Unit B, Markham, ON L3R 3J7 Canada
 Tel: 905-415-8878 • 1-855-415-8878 | Fax: 905-415-8872 • 1-855-415-8872
 Email: marketing@eelighting.ca | URL: www.eelighting.ca

Specifications and dimensions subject to change without notice.
 Consult your Energy Efficient Lighting Representative
 for availability and ordering information.