



# Core & Coil (71A) HPS 200W - 400W

## CORE & COIL HID HPS BAL 250W S50 QUAD KIT

The basic ballast is the open core and coil which is most often used as a component within a lighting luminaire. The core and coil also forms the nucleus of Philips Advance's five other ballast configurations.

### Product data

#### • General Characteristics

|                           |                      |
|---------------------------|----------------------|
| Lamp Type                 | 250W HPS             |
| Number of Lamps           | 1 piece              |
| Line Voltage              | 120/208/240/277 V    |
| Input Current (Operating) | 2.5/1.47/1.25/1.09 A |
| Line Frequency            | 60 Hz                |
| Circuit Type              | CWA                  |
| Ballast Type              | Magnetic HID         |
| Base Model                | 71A8291              |
| Core Size                 | 4 x 4 (2 coil)       |
| Suitable for Outdoor use? | Yes                  |
| Ignitor Catalog Number    | LI501-H4             |
| Ignitor Temp Rating       | 105°C                |
| Capacitor value [µF]      | 35 MFD               |
| Capacitor Catalog Number  | 7C350P24RA           |
| Capacitor Requirements    | 240V                 |
| Capacitor Temp Rating     | 105°C                |
| Capacitor Dia/Oval Dim    | 1.65 in              |
| Capacitor Height          | 3.7 in               |
| Family Name               | Core & Coil HPS      |

#### • Operating Characteristics

|                               |                       |
|-------------------------------|-----------------------|
| Automatic restart             | No                    |
| Input Voltage at Lamp Dropout | 82/139/158/184 V      |
| Nominal Open Circuit Voltage  | 187 V                 |
| Imp. Current (Open Circuit)   | 1.53/0.95/0.77/0.63 A |

|   |  |
|---|--|
| Input Current (Starting)                    | 1.61/0.89/0.8/0.68 A                     |
| Input Current Short Circuit                 | 1.16-1.74/0.64-0.96/0.56-0.85/0.49-0.7 A |
| Secondary ShortCircuit Current              | 3.65-4.45 A                              |
| Input Power Gear Constant wattage deviation | 295 W Within Trapezoid                   |
| Ballast factor                              | 1 -                                      |
| Power Factor                                | 0.90                                     |

#### • Wiring Characteristics

|                                |           |
|--------------------------------|-----------|
| Wire Striplength               | 0.5 mm    |
| Wire Length by Color           | 12"       |
| Wire Type                      | Stranded  |
| Allowed Wiring Config(Remote)  | Yes       |
| Max Dist. Ball to Lamp(Remote) | 2'        |
| Recommended Fuse               | 7/4/4/3 A |

#### • System Chars on driver level

|                  |      |
|------------------|------|
| Rated Lamp Watts | 250W |
|------------------|------|

#### • Product Dimensions

|                 |         |
|-----------------|---------|
| Length A1       | 4.8 in  |
| Length A2       | 4.4 in  |
| Width B1        | 4.3 in  |
| Coil Depth C1   | 3.82 in |
| Stack Height C2 | 1.8 in  |
| Width B2        | 3.9 in  |

**PHILIPS**

# Core & Coil (71A) HPS 200W - 400W

## • Approval & Application Chars

|                          |                |
|--------------------------|----------------|
| Approbation Marks        | ULR, CSA, RoHS |
| CE marking               | No             |
| VDE certificate          | No             |
| UL Listed                | No             |
| CSA certificate          | Yes            |
| CCC certificate          | No             |
| Chia Quality Certificate | No             |
| Temperature marking      | B/B/B/B        |
| CEC Listing              | No             |
| cUL certificate          | No             |
| EISA                     | No             |
| ETL Certificate          | No             |
| FIDE Certificate         | No             |
| NOM certificate          | No             |
| RoHS Compliant           | Yes            |
| SASO Certificate         | No             |
| UL Recognized            | Yes            |
| ANSI Code                | S50            |

|                                |           |
|--------------------------------|-----------|
| HiPot Test (1 minute)          | 2000 V    |
| HiPot Test (2 seconds)         | 2500 V    |
| Open Circ Voltage Test (Volts) | 170-205 V |
| UL Insulation Class            | H(180°C)  |
| UL Temperature Code            | 1029B     |

## • Product Data

|                    |                           |
|--------------------|---------------------------|
| Product number     | 71A8291600                |
| Full product name  | HPS BAL 250W S50 QUAD KIT |
| Short product name | HPS BAL 250W S50 QUAD KIT |
| Pieces per Sku     | 1                         |
| Skus/Case          | 4                         |
| Bar code on pack   | 781087033746              |
| Bar code on case   | 50781087033741            |
| Logistics code(s)  | 913700505561              |
| eop_net_weight_pp  | 4.940 kg                  |

## Dimensional drawing

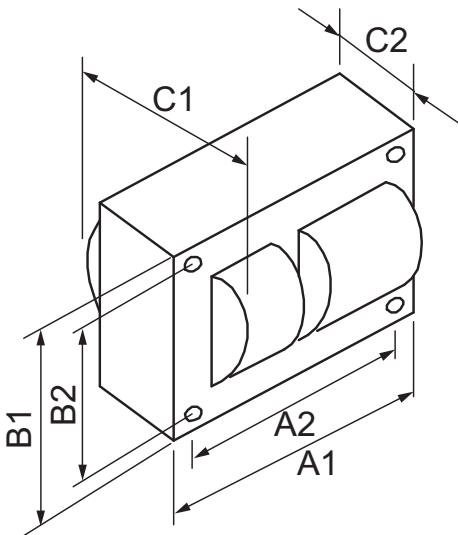

## CORE & COIL HID HPS BAL 250W S50 QUAD KIT

| Product                   | A1 (Norm) | A2 (Norm) | A3 (Norm) | B1 (Norm) | B2 (Norm) | C1 (Norm) | C2 (Norm) |
|---------------------------|-----------|-----------|-----------|-----------|-----------|-----------|-----------|
| HPS BAL 250W S50 QUAD KIT | 4.8       | 4.4       | -         | 4.3       | 3.9       | 3.82      | 1.8       |

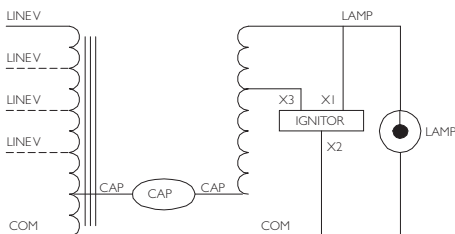

© 2014 Koninklijke Philips N.V. (Royal Philips)  
All rights reserved.

Specifications are subject to change without notice. Trademarks are the property of Koninklijke Philips N.V. (Royal Philips) or their respective owners.

[www.philips.com/lighting](http://www.philips.com/lighting)

2014, March 26  
data subject to change